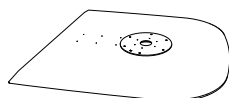
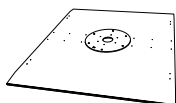
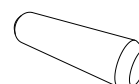
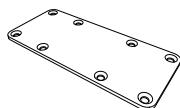
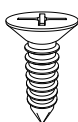
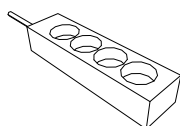
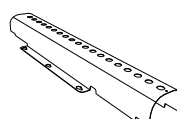
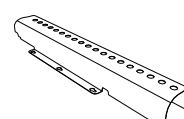
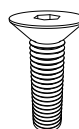

bastille

BY JONAS WAGELL

Mötesbord 340x120cm.

Meeting table 340x120cm.

**innehåll** *content***A****x 2****B****x 1****C****(x 3)****D****x 6****E****x 4****F****x 32****G****x 1****H****x 2****I****x 18****J****(x 1)****K****(x 2)****L****(x 2)****M****(x 24)****N****x 3****O****x 6**

bastille

BY JONAS WAGELL

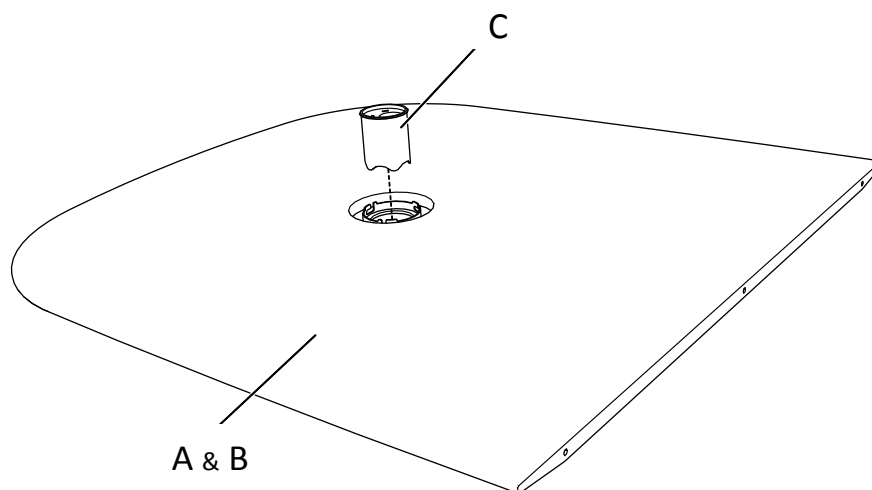
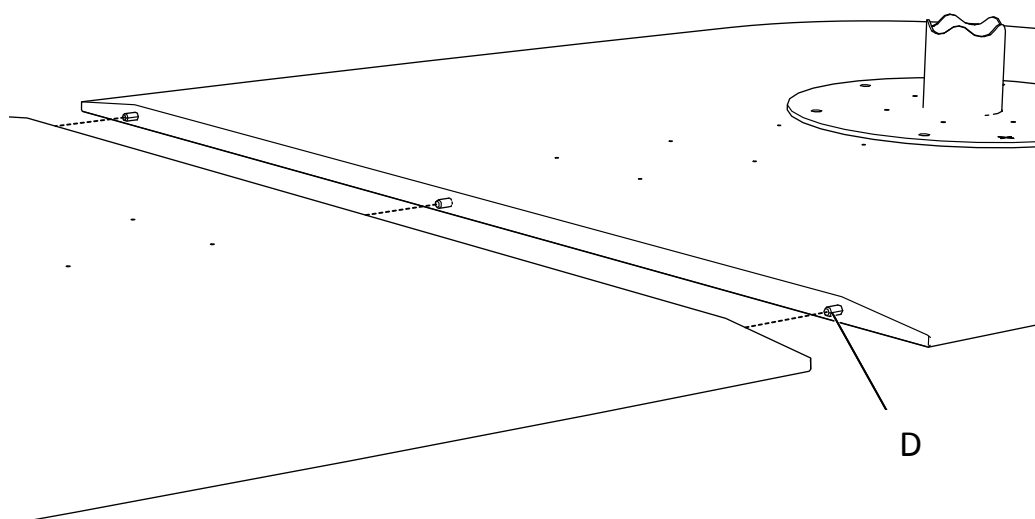
1**2****information information**

Montera eventuella eluttag "C" i skivfästen på samtliga skivor. Placera ut de olika skivorna på ett plant underlag. Montera tapparna "D" i hålen på skivor "A", likt bild och skjut ihop dem.
Mount any electrical outputs "C" onto the top discs on the table tops. Place the tops on an even surface. Assemble dowels "D" on the end of the table tops "A" and push them together.

bastille

BY JONAS WAGELL

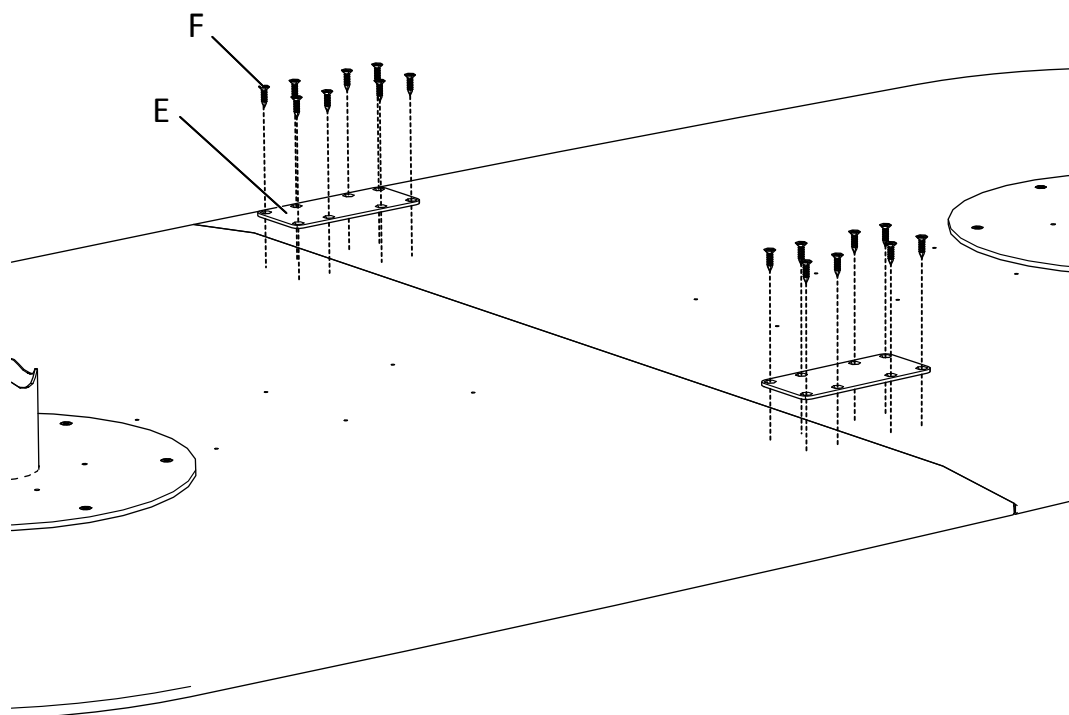
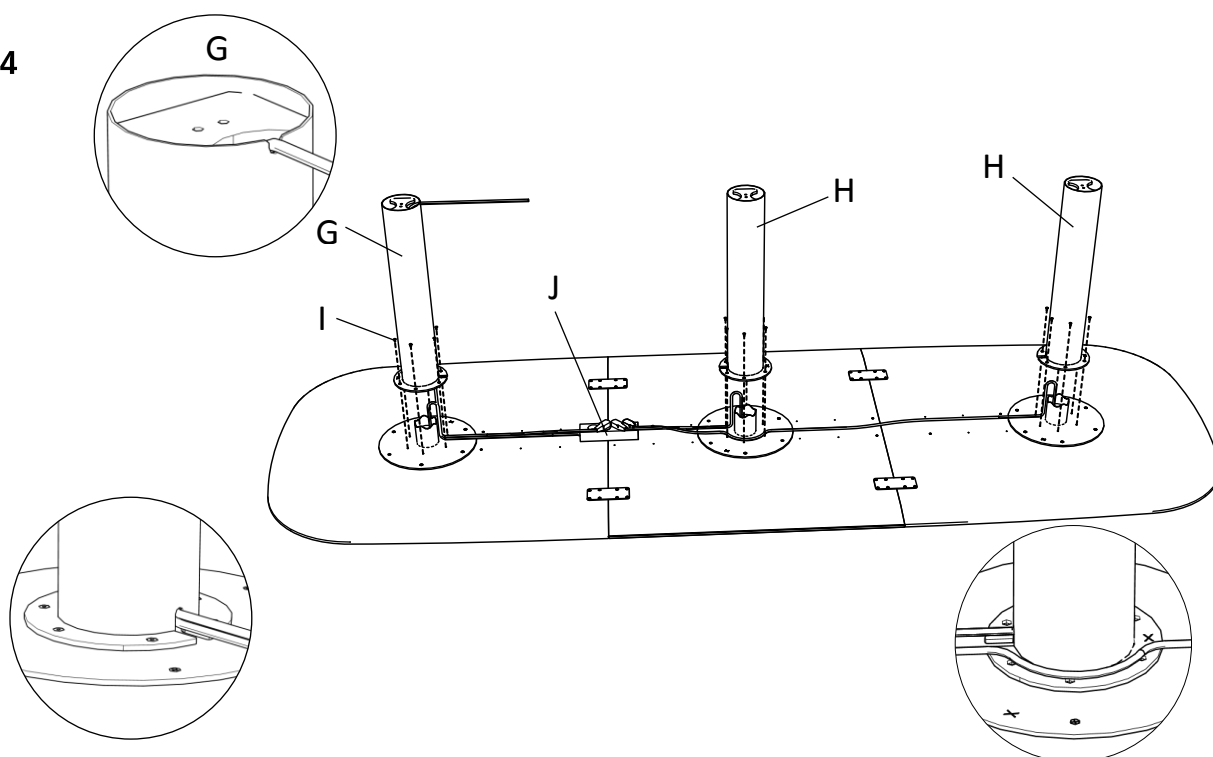
3**4****information information**

Montera sedan kopplingarna "E" i de förborrade hålen på skivan, börja på ena skivan först. Dra sladden på grendosan "J" genom ena pelarröret "G" med ett urtag i botten. Dra ur sladdarna ur toppen av pelarna. Sladden från pelaren på motsatt sida av pelare "G" dras förbi utsidan av mittpelaren.

Assemble the top connectors "E" by using the pre-drilled holes on the table top, start the assemble on one of the tops. Pull the cord of the extension lead "J" through the pillar "G" with a recess at the bottom. Exit the cable at the top of the pillars. The cord from the pillar on the opposite side of pillar "G" is guided past the outside of the middle pillar.

bastille

BY JONAS WAGELL

5

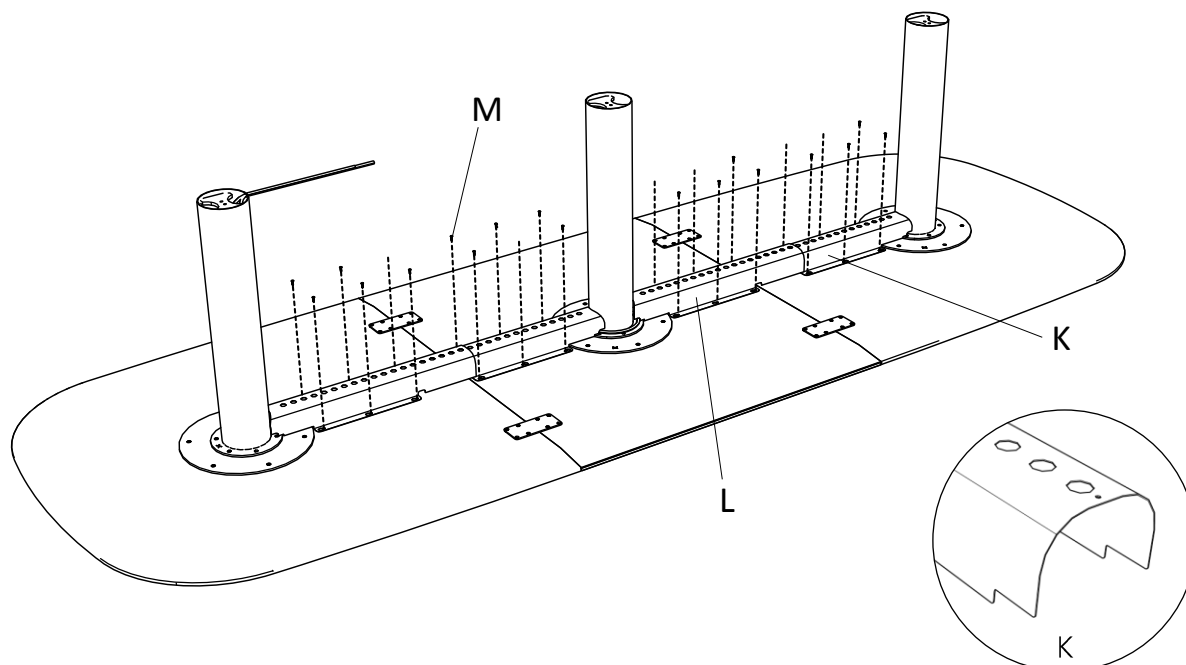

6

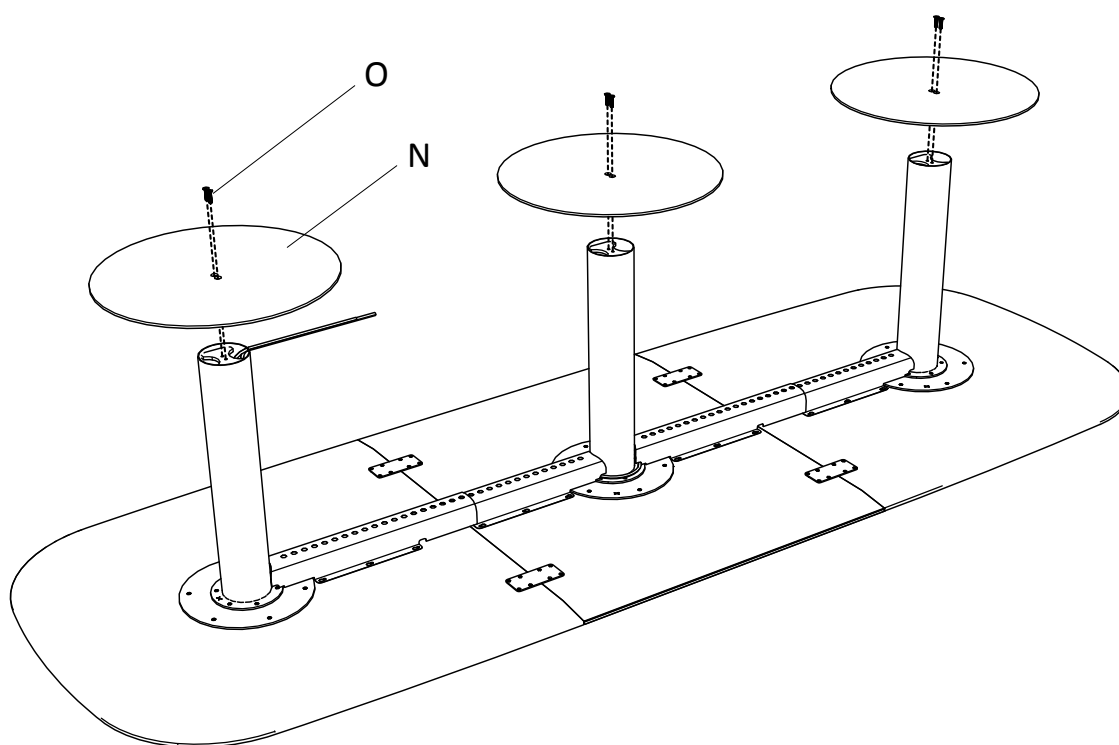
**information information**

Skruva fast inre kabeldiken "K" i de förborrade hålen på skivan, därefter skruva fast yttre kabeldiken "L". Montera därefter bottenplattorna "N". Dra åt skruvarna ordentligt.

Mount the inner cable ducts "K" in the pre-drilled holes on the table tops, afterwards mount the outer cable ducts "L". Mount the bottom plates "N". Make sure to tighten the screws firmly.